

# End Stop

## Direct Bury End Cap



### Description

This end stop connector is used for closing microducts.

- Transparent body
- IP68
- Push fit connection
- Removal of the end stop is easily achieved by pressing the collet inwards
- Manufactured in compliance with EN50411-2-8
- Supplied with tamper-proof locking clip which prevents accidental disconnection



### Material

Body	Cartridge	Collet	Seals	Lock Claws	Compression Nut	Support ring
Transparent HP Polymer	Techno Polymer	Techno Polymer	NBR	Stainless Steel	Techno Polymer	Techno Polymer

### Technical information

Blowing Pressure (long term)	Max. Blowing Pressure (short term)	Estimated lifetime	Protection Class	Operating temperature
15 bar	25 bar	min. 20 years	IP68	-20 °C to +50 °C

### Dimensions

D [mm]	E [mm]	L [mm]
3	14.8	18.3
5	16.8	19.5
7	18.8	21.5
8	18.8	21.5
10	22.2	25.1
12	25.0	26.3
14	26.7	27.0
16	29.2	29.9
18	32.0	31.5
20	34.0	33.2
25	41.2	37.5

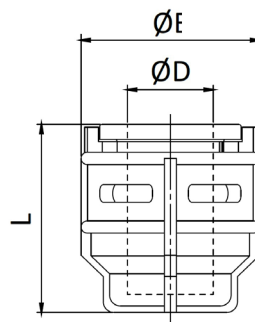

Certified by:



# End Stop

## Direct Bury End Cap



### Tests

Test	Test Standard
Microduct Retention	EN 61300-2-4
Crush Resistance	EN 61300-2-10
Impact	EN 60794-1-2:2003, Method E4
Re-entries	EN 61300-2-33
Change of Temperature (Cycling)	EN 61300-2-22
Water Immersion	EN 61300-2-23:1997, Method 2
Salt Mist	EN 61300-2-26
Chemical Resistance	EN 61300-2-34
High Pressure Resistance (Safety)	EN 50411-2-8, Annex C
Installation Test	EN 50411-2-8, Annex D
Insertion Force	EN 50411-2-8, Annex E
IP 68	EN 60529
Glow Wire Test at 750°C	EN 61386-22
Conduit Systems Buried Underground	EN 61386-24

Certified by:

