

# Connector

## Direct Bury Reducing Connector



### Description

This push-fit connector is used to connect microducts with different diameter to provide a dedicated link for either pulling or blowing fibre optic cables. It is suitable for direct buried applications.

- transparent body
- IP68
- push fit connection
- removal of the connector is easily achieved by pressing the collet inwards
- manufactured in compliance with EN50411-2-8
- supplied with tamper-proof locking clip which prevents accidental disconnection



### Material

Body	Cartridge	Collet	Seals	Lock Claws	Compression Nut	Support ring
Transparent HP Polymer	Techno Polymer	Techno Polymer	NBR	Stainless Steel	Techno Polymer	Techno Polymer

### Technical information

Blowing Pressure (long term)	Max. Blowing Pressure (short term)	Estimated lifetime	Protection Class	Operating Temperature
15 bar	25 bar	min. 20 years	IP68	-20°C to +50°C

### Dimensions

D1 [mm]	D2 [mm]	E1 [mm]	E2 [mm]	A1 [mm]	A2 [mm]	L [mm]
7	4	18.8	14.0	6.1	3.0	36.2
7	5	18.8	16.8	6.1	4.3	37.4
7	6	18.8	16.8	6.1	5.3	37.4
14	10	26.7	22.2	12.0	9.3	48.3
14	12	26.7	25.0	12.0	11.0	49.7
16	12	29.2	25.0	15.0	11.0	52.4
16	14	29.2	26.7	15.0	13.0	53.1
18	14	32.0	26.7	16.0	12.0	54.4

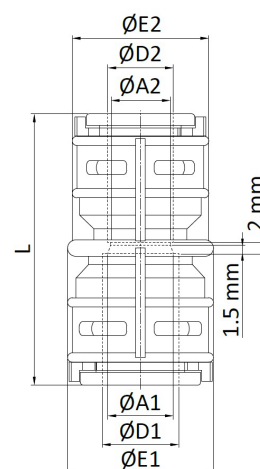

Certified by:



# Connector

## Direct Bury Reducing Connector



### Tests

Test	Test Standard
Microduct Retention	EN 61300-2-4
Crush Resistance	EN 61300-2-10
Impact	EN 60794-1-2:2003, Method E4
Re-entries	EN 61300-2-33
Change of Temperature (Cycling)	EN 61300-2-22
Water Immersion	EN 61300-2-23:1997, Method 2
Salt Mist	EN 61300-2-26
Chemical Resistance	EN 61300-2-34
High Pressure Resistance (Safety)	EN 50411-2-8, Annex C
Installation Test	EN 50411-2-8, Annex D
Insertion Force	EN 50411-2-8, Annex E
IP 68	EN 60529
Glow Wire Test at 750°C	EN 61386-22
Conduit Systems Buried Underground	EN 61386-24



Certified by:

